

# DVOSOBAN STAN U3.04

## LAMELA 2 ULAZ 3

	P (m <sup>2</sup> )
1. ULAZ	10.54
2. DNEVNA SOBA SA TRPEZARIJOM	26.84
3. KUHINJA	6.58
4. HODNIK	1.28
5. KUPATILO	5.99
6. SPAVAĆA SOBA	14.40
	65.63
7. TERASA	8.53
UKUPNO	74.16

Broj stana	/	5	11	17	23	29	35	41
Sprat	II	III	IV	V	VI	VII	VIII	IX

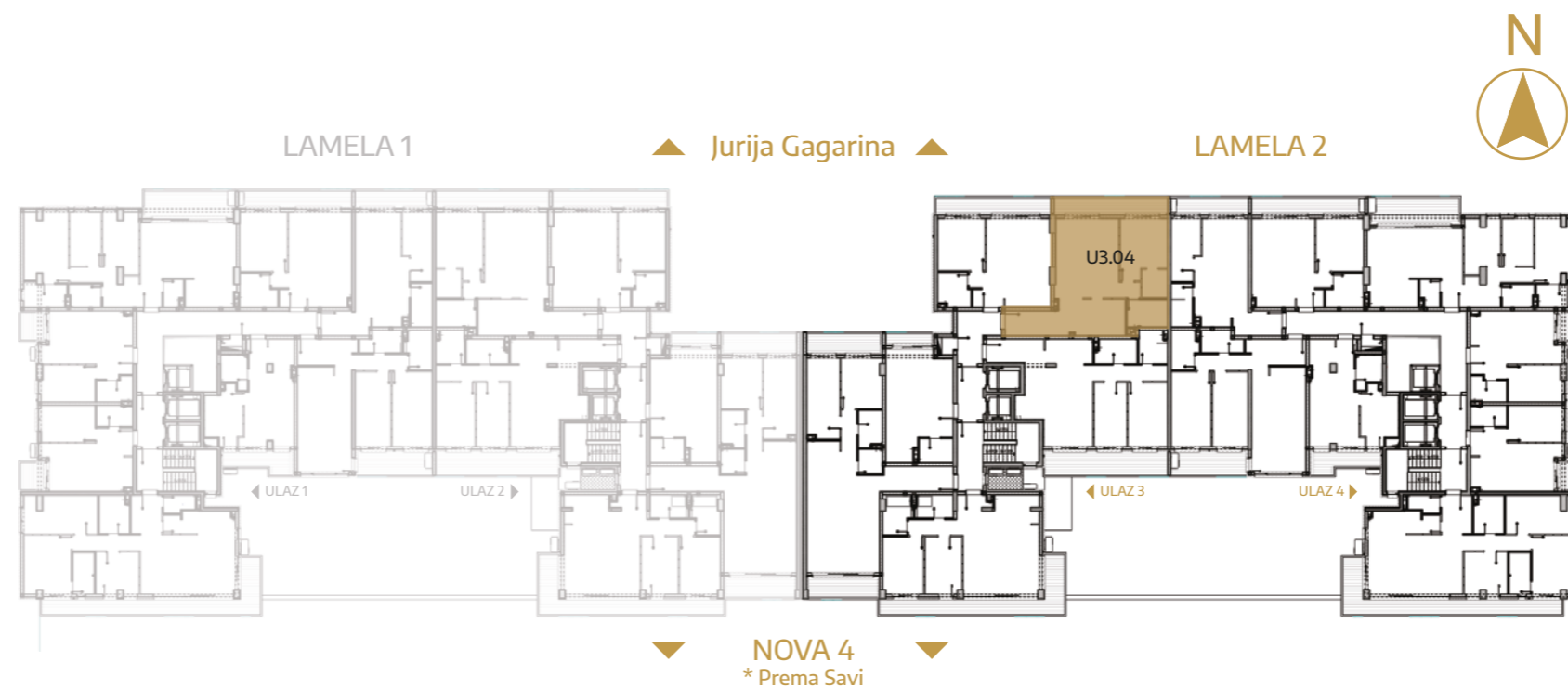

# OSNOVA I 3D PRIKAZ

