

# JEDNOSOBBAN STAN U3.01

## LAMELA 2 ULAZ 3

	P (m <sup>2</sup> )
1. ULAZ	3.64
2. DNEVNA SOBA SA TRPEZARIJOM	22.05
3. KUHINJA	5.56
4. KUPATILO	3.95
	35.20
5. TERASA	2.18
UKUPNO	37.38

Broj stana	/	3	/	/	21	/	/	39
Sprat	II	III	IV	V	VI	VII	VIII	IX

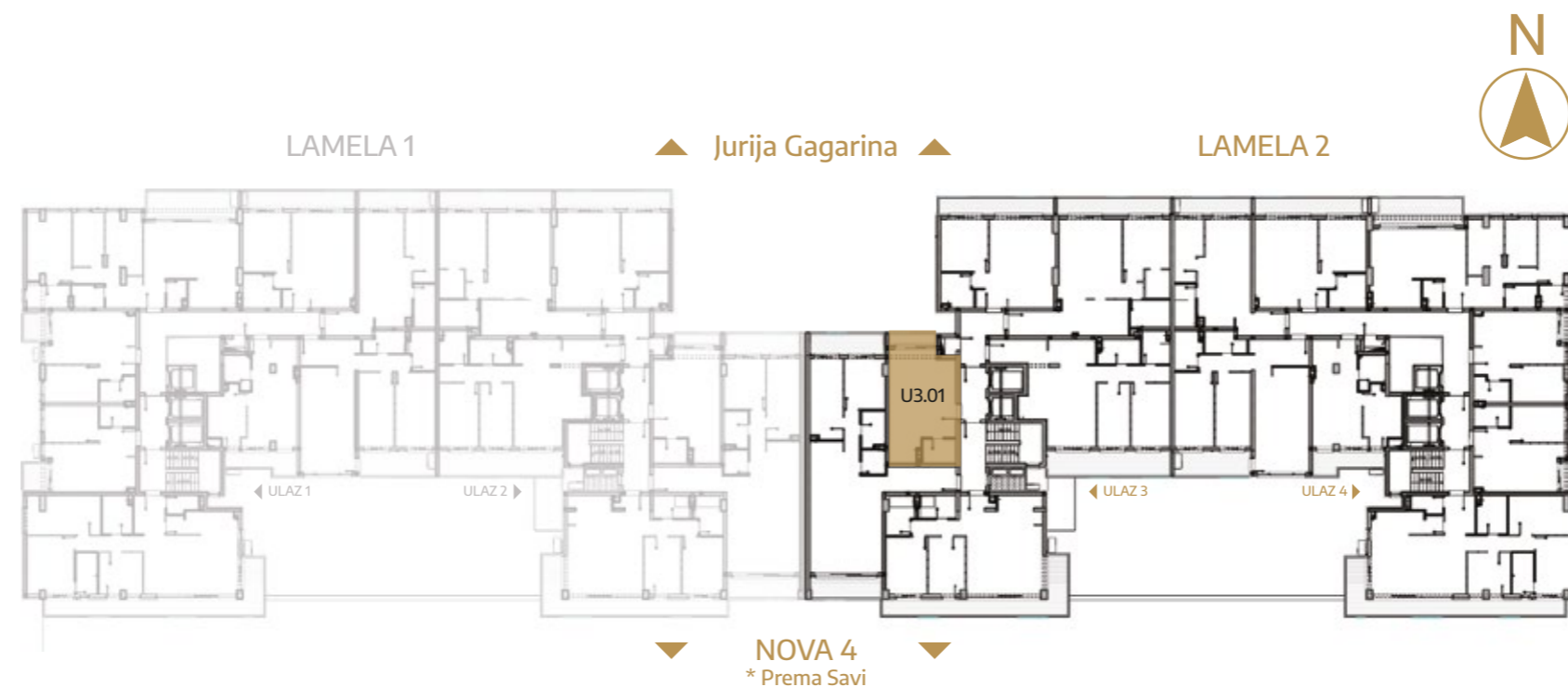

# OSNOVA I 3D PRIKAZ

